

General Information

A. 8-Series Bikes/Crosstrainers/Steppers/Gauntlet

Quickstart Keypad

Part Number: [050-5668](#)
Plugs directly into PCB.



Blank Overlay

Part Number: [701-0062](#)



MYE 800/900MHz Keypad

Part Number: [050-2353](#)
Plugs directly into Wireless Receiver Board.



Embedded Keypad

Part Number: [050-2364](#)
CCB PN: 701-0143

CCB is only sold in a kit with the keypad
Part Number: [701-0061](#)



PVS Keypad

Part Number: [050-2365](#)
CCB PN: 715-3911

CCB is only sold in a kit with the keypad
Part Number: [701-0061-KT](#)



General Information

B. 8-Series Treadmill/Treadclimber

Quickstart Keypad

Part Number: [050-2363](#)
Plugs directly into PCB.



Blank Overlay

Part Number: [701-0062](#)



MYE 800/900MHz Keypad

Part Number: [050-2353](#)
Plugs directly into Wireless Receiver Board.



Embedded Keypad

Part Number: [050-2364](#)
CCB PN: 701-0143

CCB is only sold in a kit with the keypad
Part Number: [701-0061](#)



PVS Keypad

Part Number: [050-2365](#)
CCB PN: 715-3911

CCB is only sold in a kit with the keypad
Part Number: [701-0061-KT](#)



General Information

C. E-Series Bikes/Crosstrainers/Steppers

Quickstart Keypad

Part Number: [050-2028](#)
Plugs directly into PCB.



Upper Only, Quickstart Keypad

Part Number: [050-2203](#)
Plugs directly into PCB.



Lower Only, Blank Overlay

Part Number: [050-2221](#)



Quickstart, iPod with PVS

Part Number: [050-2027](#)
CCB PN: [718-5092](#)



Quickstart, USB/iPod

Part Number: [050-2146](#)
CCB PN: [718-5155](#)

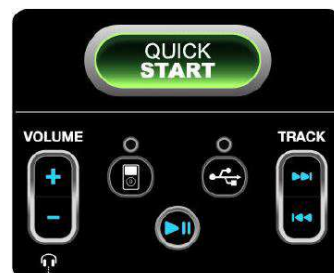

General Information

Quickstart, USB/iPod, MYE with 800/900Mhz

Part Number: [050-2147](#)

Plugs directly into Wireless Receiver Board.



Lower Only, USB/iPod, PVS with 800/900Mhz

Part Number: [050-2209](#)

Plugs directly into Wireless Receiver Board.



Quickstart, USB/iPod/**Embedded**

Part Number: [050-2148](#)

CCB PN: [718-5156](#)



Lower Only, USB/iPod/**PVS**

Part Number: [050-2207](#)

CCB PN: [718-5156](#)



General Information

D. E-Series Treadmill/Treadclimber

Quickstart & Stop

Part Number: [050-2030](#)
Plugs directly into PCB.

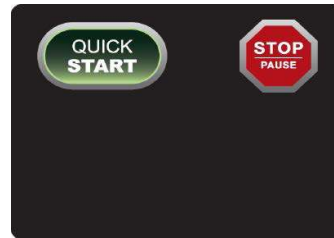

Upper Only, Quickstart & Stop

Part Number: [050-2204-KT](#)
Plugs directly into PCB.



Lower Only, Blank Overlay

Part Number: [050-2221](#)



Quickstart & Stop, USB/iPod

Part Number: [050-2149](#)
CCB PN: [718-5155](#)



Lower Only, USB/iPod

Part Number: [050-2208](#)
CCB PN: [718-5155](#)

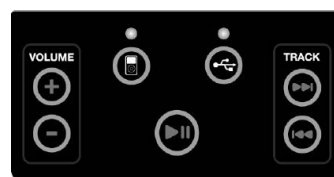

General Information

Quickstart & Stop, iPod with PVS

Part Number: [050-2031](#)
 CCB PN: [718-5092](#)

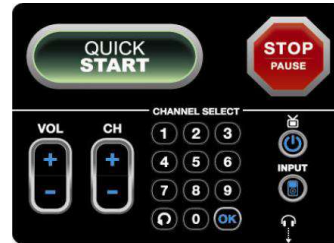

Lower Only, iPod with PVS

Part Number: [050-2248](#)
 CCB PN: [715-3911](#)



Quickstart & Stop, USB/iPod, MYE with 800/900Mhz

Part Number: [050-2150](#)
 Plugs directly into Wireless Receiver Board.

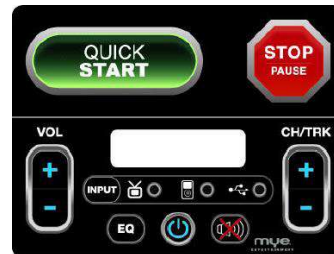

Lower Only, MYE with 800/900Mhz

Part Number: [050-2255](#)
 Plugs directly into Wireless Receiver Board.



Quickstart & Stop, USB/iPod/PVS

Part Number: [050-2151](#)
 CCB PN: [718-5155](#)

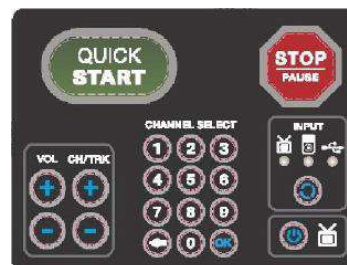

General Information

E. S-Series Bikes/Crosstrainers/Steppers

PVS Control

Part Number: [740-0014](#)
 CCB PN: [718-5092](#)



PVS Control

Part Number: [050-2218](#)
 CCB PN: [718-5092](#)



General Information

F. S-Series Treadmill

PVS Control

Part Number: 050-2219
 CCB PN: [718-5092](#)

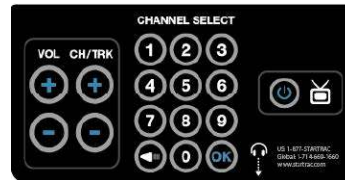

PVS Control

Part Number: [740-6038-KT](#)
 CCB PN: [718-5092](#)

